

窄系列焊接弯板链 Narrow Series Welded Crank-Link Mill Chains

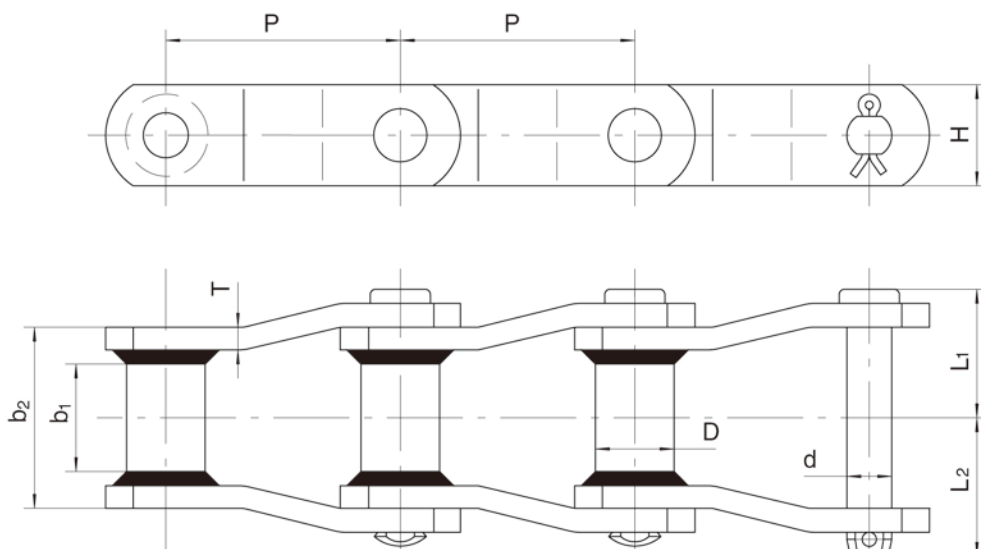

链号 Chain No.	节距 Pitch	窄端 Narrow end		套筒外径 Bush diameter	链板 Sidebars		销轴 Pin			最小抗拉强度 Ultimate tensile strength	许用工作载荷 Rated working load	每米重量 Weight per meter
	P mm	b ₁ (min) mm	b ₂ (max) mm	D(max) mm	h mm	T mm	d mm	L ₁ mm	L ₂ mm	Fu (min) kN	kN	q kg/m
WR78	66.27	28.4	51	22.23	28.6	6.4	12.7	36.3	39.5	106.8	10.5	5.94
DWR78	66.27	28.4	51	21.4	31.8	6.4	12.7	36.3	39.5	125	12.1	6.42
WR78B	66.27	28.4	51	27	31.8	6.4	12.7	36.3	39.5	125	12.1	7.03
WSR78	66.27	20	41.3	21.3	25.4	6.4	12.7	31.5	34.6	85.3	8.3	5.21
WR78HD	66.95	25.4	51.2	25.4	31.8	9.5	14.27	40.2	45.3	133.4	14.7	9.41
WR82	78.1	31.8	57.4	25.4	31.8	6.4	14.27	40	43.5	133.4	14.7	6.83
*WR82SS	78.1	31.8	57.4	25.4	31.8	6.4	14.27	40	43.5	133.4	14.7	6.83
WR82HD	78.1	28.6	60.8	31.75	38.1	9.5	19.05	46.5	50.8	215	20.5	12.71
WR124	101.6	38.1	71.5	31.8	38.1	9.5	19.05	52	56	204	20.5	11.52
WR124HD	103.2	38.1	76.3	41.28	50.8	12.7	25.4	59.4	64.3	378	46.5	21.33
WR111	120.9	50.8	85.6	31.8	44.5	9.5	19.05	59.4	63.3	270	32.5	13.05
WR106	152.4	38.1	71.5	31.8	38.1	9.5	19.05	52	56	204	20.5	9.65
WR110	152.4	44.5	76.5	31.8	38.1	9.5	19.05	54.4	59.6	204	20.5	9.57
WR132	153.67	69.85	111.6	44.5	50.8	12.7	25.4	77.3	81.7	345	42.5	21.08
WR150	153.67	69.85	111.6	44.5	63.5	12.7	25.4	77.3	81.7	345	42.5	24.93

带“*”材质为不锈钢

With “*” means stainless steel material.

链条销轴经过热处理硬化，链板和套筒不热处理

All pins of chain have been hardened through heat treatment. Sidebar and bush have not been heat treated!

窄系列焊接弯板链 Narrow Series Welded Crank-Link Mill Chains

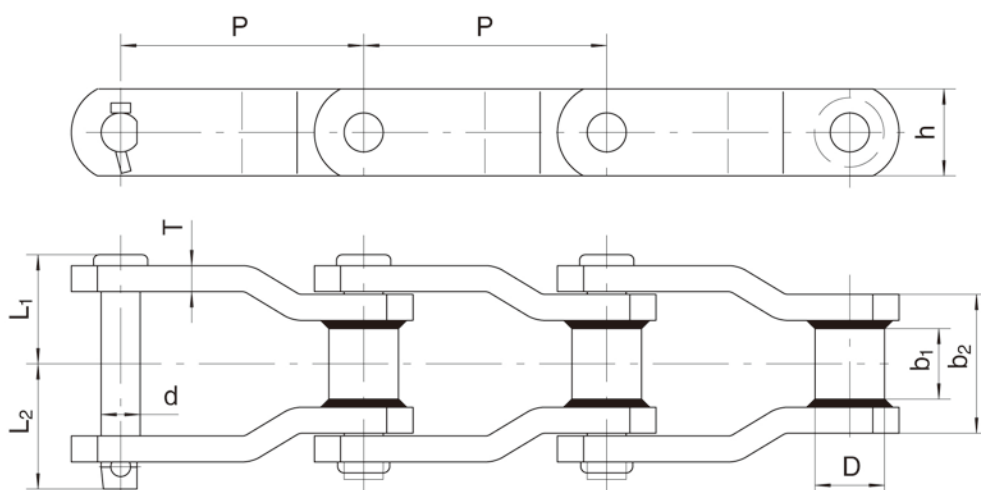

链号 Chain No.	节距 Pitch	窄端 Narrow end		套筒外径 Bush diameter	链板 Sidebars		销轴 Pin			最小抗拉强度 Ultimate tensile strength	许用工作载荷 Rated working load	每米重量 Weight per meter
	P mm	b ₁ (min) mm	b ₂ (max) mm	D(max) mm	h mm	T mm	d mm	L ₁ mm	L ₂ mm	Fu (min) kN	kN	q kg/m
WH78	66.27	28.4	51	22.23	28.6	6.4	12.7	36.3	39.5	160	15.6	5.92
WH78B	66.27	28.4	51	27	31.8	6.4	12.7	36.3	39.5	160	15.6	6.98
WH78HD	66.95	25.4	51.2	25.4	31.8	9.5	14.27	40.2	45.3	200	19.6	9.4
WH82	78.1	31.8	57.4	27	31.8	6.4	14.27	40	43.5	200	19.6	7.14
WH82HD	78.1	28.6	60.8	31.75	38.1	9.5	19.05	46.5	50.8	320	32.7	12.7
WH9103HD	78.1	28.6	57.9	31.75	38.1	9.5	18.95	43.5	48.4	320	32.9	11.9
WH124	101.6	38.1	71.5	31.8	38.1	9.5	19.05	52	56	320	32.7	11.5
WH124HD	103.2	38.1	76.3	41.28	50.8	12.7	25.4	59.4	64.3	540	66.8	21.3
WH111	120.9	50.8	85.6	31.8	44.5	9.5	19.05	59.4	63.3	320	39.5	13
WH720	152.4	28.5	55	32	40	10	19.05	44.5	49.5	350	35.8	9.7
WH106	152.4	38.1	71.5	31.8	38.1	9.5	19.05	52	56	320	32.7	9.6
WH110	152.4	44.5	76.5	31.8	38.1	9.5	19.05	54.4	59.6	320	32.7	9.6
WH132HD	153.67	69.85	119.03	44.5	50.8	15.9	25.4	84	89.7	540	69.3	24.8

所有零件经过热处理硬化

All components of chain have been hardened through heat treatment.

窄系列焊接弯板链 Narrow Series Welded Crank-Link Mill Chains

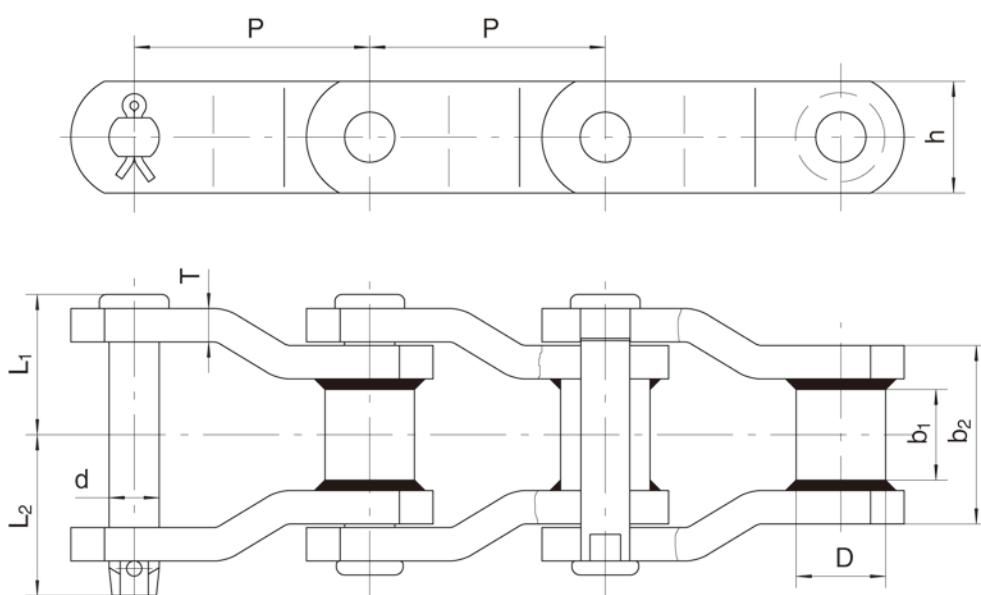

链号 Chain No.	节距 Pitch	窄端 Narrow end		套筒外径 Bush diameter	链板 Sidebars		销轴 Pin			最小抗拉强度 Ultimate tensile strength	许用工作载荷 Rated working load	每米重量 weight per meter
		b ₁	b ₂		h mm	T mm	d mm	L ₁ mm	L ₂ mm			
		(min) mm	(max) mm									
WHX124	101.6	38.1	71.5	36.55	38.1	9.5	19.05	51.8	56.2	320	32.7	12.5
WHX124HD	103.2	38.1	76.3	41.28	50.8	12.7	25.4	59.4	64.3	540	66.8	20.7
WHX111	120.9	50.8	85.6	36.55	38.1	9.5	19.05	58.7	64.5	320	39.5	12.5
WHX111HD	120.9	57.15	91.96	36.53	50.8	12.7	19.05	65.5	69.5	320	39.5	19.1
WHX132	153.67	69.85	111.6	44.5	50.8	12.7	25.4	77.3	81.7	540	66.8	20.4
WHX132HD	153.67	69.85	119.03	44.5	50.8	15.9	25.4	84	89.7	540	69.3	24.8
WHX106	152.4	38.1	71.5	36.55	38.1	9.5	19.05	51.8	56.2	320	32.7	9.7
WHX150	153.67	69.85	111.6	44.5	63.5	12.7	25.4	77.3	81.7	540	66.8	24.5
FWHX150	153.67	69.85	110	44.5	65	12	25	75	81	520	64.5	24.7
WHX155	153.67	69.85	112.1	44.5	63.5	14.3	28.4	77.4	87.5	660	77.8	27.7
WHX157	153.67	69.85	118.1	44.5	63.5	15.9	28.55	81.4	92.6	750	80.9	29.3
WHX159	155.58	73	118.1	50.8	76.2	15.9	31.5	83	84.8	930	90	38.4
WHX4855	304.8	69.85	116.9	44.5	63.5	15.9	31.55	81.8	84.3	780	76.8	22.5
WHX4859	304.8	73	118.1	50.8	76.2	15.9	31.5	83	84.8	930	87.5	28.9

所有零件经过热处理硬化，销轴表面感应硬化处理

All components of chain have been hardened through heat treatment and pin has been surface induction hardened.